

Courses & Distances of the Creek

S 43 W	98
S 12 W	124
S 1 E	64
	<hr/>
	286

C. 123. 289

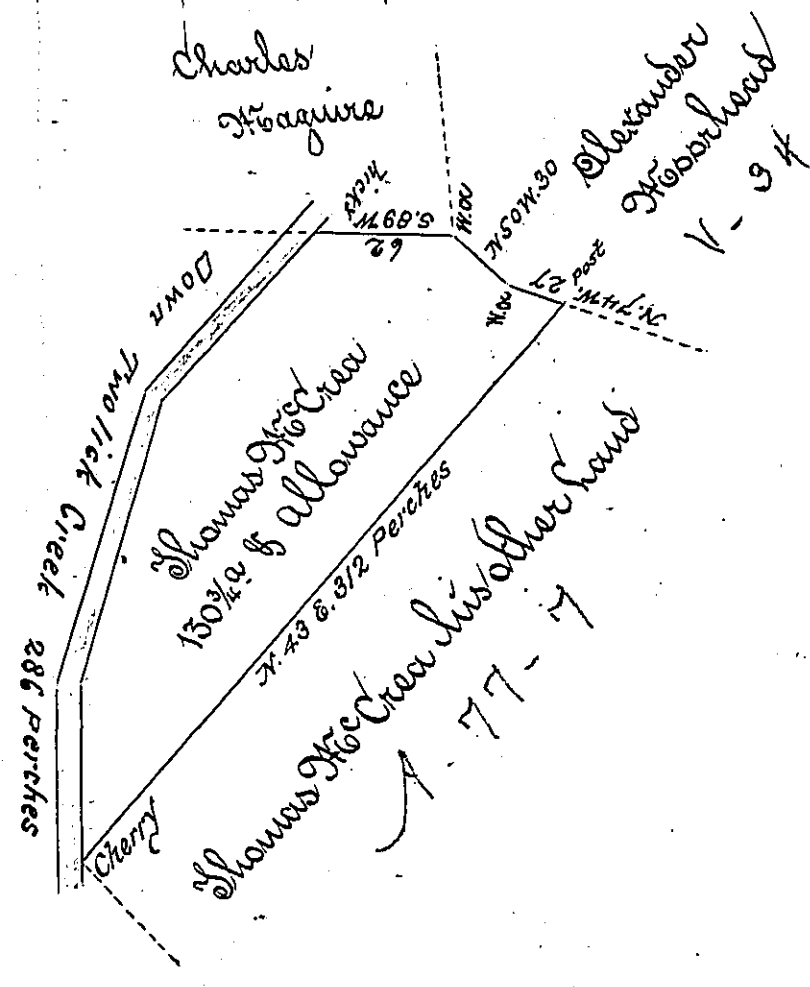

Survey'd to Thomas McCrea on the 26th of March 1787, the above described tract of one hundred & thirty acres & three quarters of an acre & Allowance of six per cent ditto late adjoining land of Alexander Hooperhead and the Chesnut Ridge and Two Lick Creek in Armstrong Township Westmoreland County. By warrant of the 26th day of August 1785.

John Lukens Esq. S. Genl.

Joshua Elder D. S.

IN TESTIMONY that the above is a copy of the original remaining on file in the Department of Internal Affairs of Pennsylvania, made conformably to an Act of Assembly approved the 16th day of February, 1833, I have hereunto set my Hand and caused the Seal of said Department to be affixed at Harrisburg, this fifth day of March 1901.

James W. Latta
Secretary of Internal Affairs.